

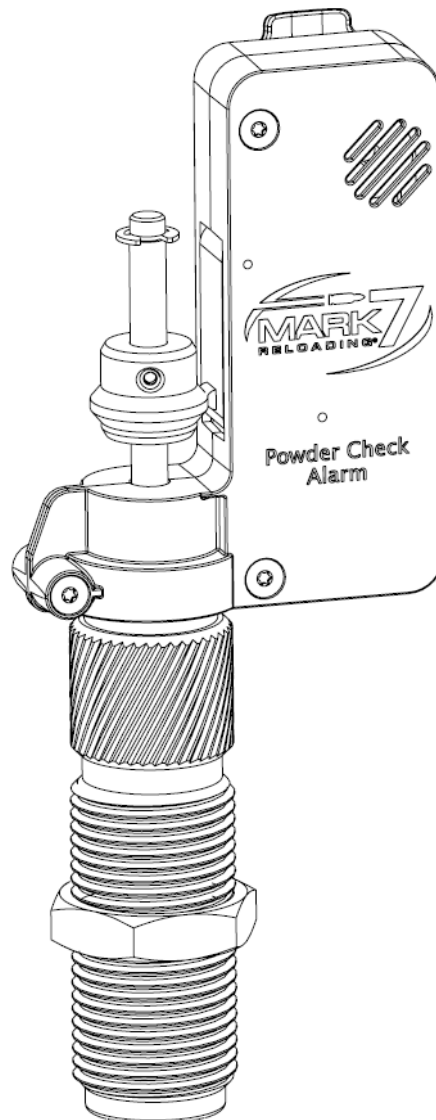

## 101-1287: Mark 7® Powder Check Alarm

### Instruction Manual V 1.0



Read this manual completely. Understand all safety and operating instructions. Failure to comply with the warnings and instructions may result in serious injury, illness or death.

## Package Content:

Please review package contents, if anything is incorrect or missing, please contact Mark 7 customer service immediately.

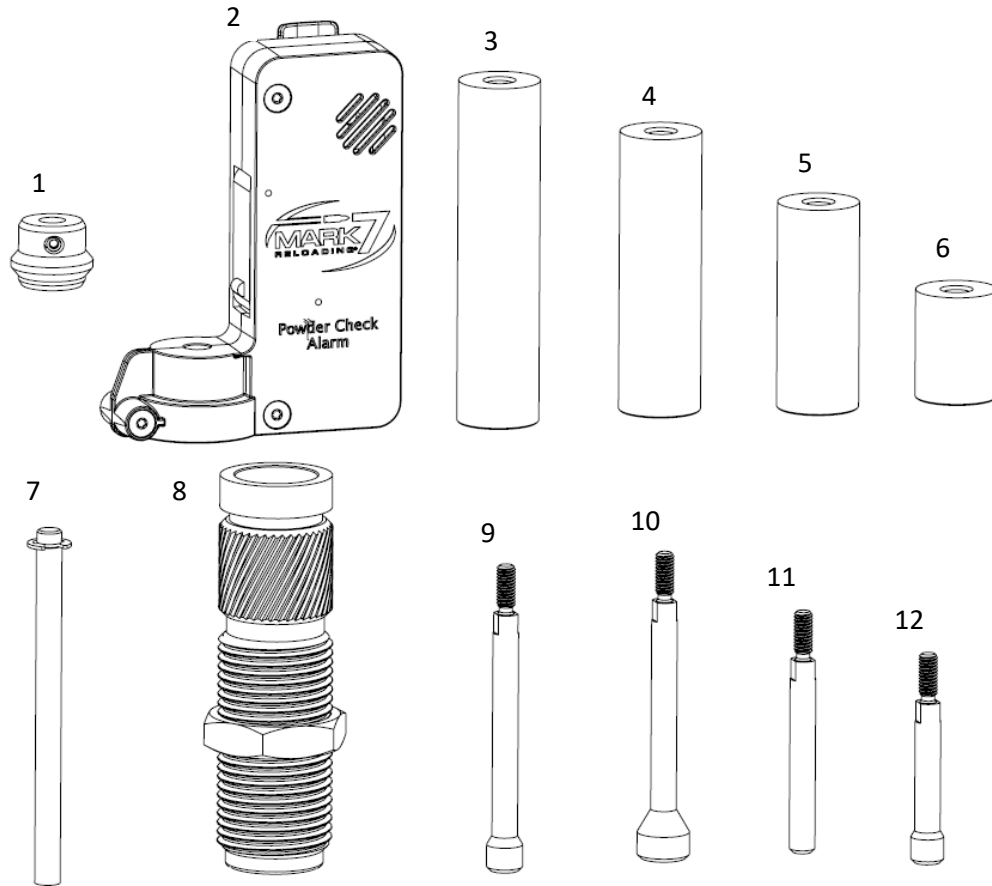

Item No.	Description	QTY
1	Alarm Trigger	1
2	Powder Check Alarm Housing Assembly	1
3	Small Die Insert	1
4	Medium Die Insert	1
5	Large Die Insert	1
6	X-Large Die Insert	1
7	Upper Rod Assembly	1
8	Powder Check Die with Thin Hex Nut	1
9	Powder Probe Tip - Small Pistol	1
10	Powder Probe Tip - Large Pistol	1
11	Powder Probe Tip - Small Rifle	1
12	Powder Probe Tip - Large Rifle	1



## Setup Procedures:

1. Choose your Die Insert based on the following table and drop it into the die body:

Small Insert	Medium Insert	Large Insert	X-Large Insert
9mm	357	223	30-06
380 Auto	38 Special	300 Blackout	338 Lapua
38 Super	44 Mag	7.62.54R	
40 S&W	45 Colt	308	
10mm	7.62x39	6.5 Creedmoor	
45 ACP			

Table 1: Common calibers that work with each insert

\*For calibers not listed, insert a case into the station you are going to set up your Powder Check Alarm then thread the Powder Check Die in and leave loose. Move the Tool Head to the down position and drop in each insert starting with the Small Insert. The correct insert will be able to sit about 1/8" proud of the top of the die body with some die height adjustment.

2. Place a case under the station you want to set up the Powder Check Alarm then move the tool head to the bottom. Thread the Powder Check Die into the station until the top of the insert is flush with the top of the die and leave loose.
3. Slide the Powder Check Die Housing over the top of the die and make sure to push the housing fully down onto the die body. Tighten the set screw on the back of the housing to lock in place.

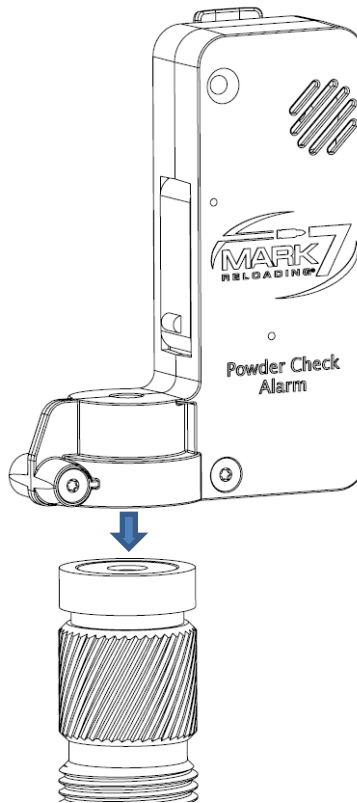

Figure 1: Mounting the Electronics Housing

- Verify there is a battery in the housing, then begin to thread the die down slowly until the buzzer starts going off, then go one last quarter turn and move the tool head to the top. Tighten the thin hex nut on the die.
- Choose your **Powder Probe Tip** for your caliber size. See below for the rod sizes for your caliber.

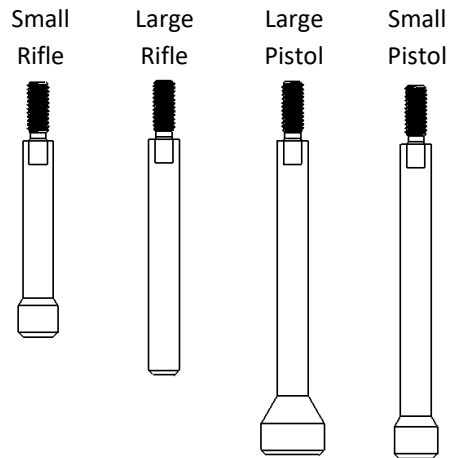

Figure 2: Powder Probe Tips.

- Slide the Trigger onto the Upper Rod and drop them into the top of the die assembly, then take the probe tip you chose and feed it up through the bottom of the die assembly. Thread the rods together tightly. Note: You may apply purple Loctite to the rod threads to prevent loosening.

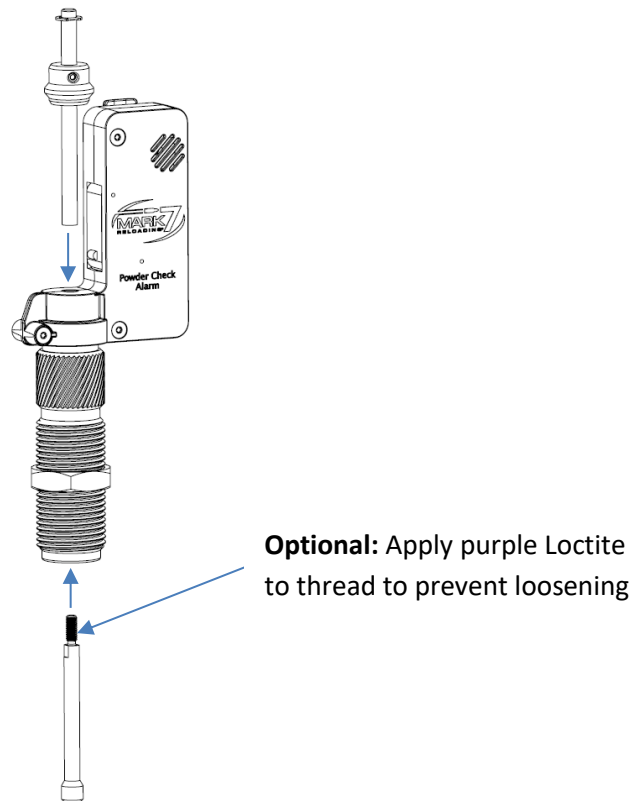

Figure 3: Assembling the Trigger and Rods onto the mounted product.



7. Place a case with the desired charge onto the shell plate under the powder check alarm station. Move the tool head to bottom to verify your alarm triggers, if so, then remove the battery and set the height of the Trigger by aligning the upper switch in the middle of the larger OD section of the Trigger and tightening the set screw. Raise the tool head and put the battery back in, then verify your height by lowering the tool head back onto the case filled with powder; the alarm should not sound.

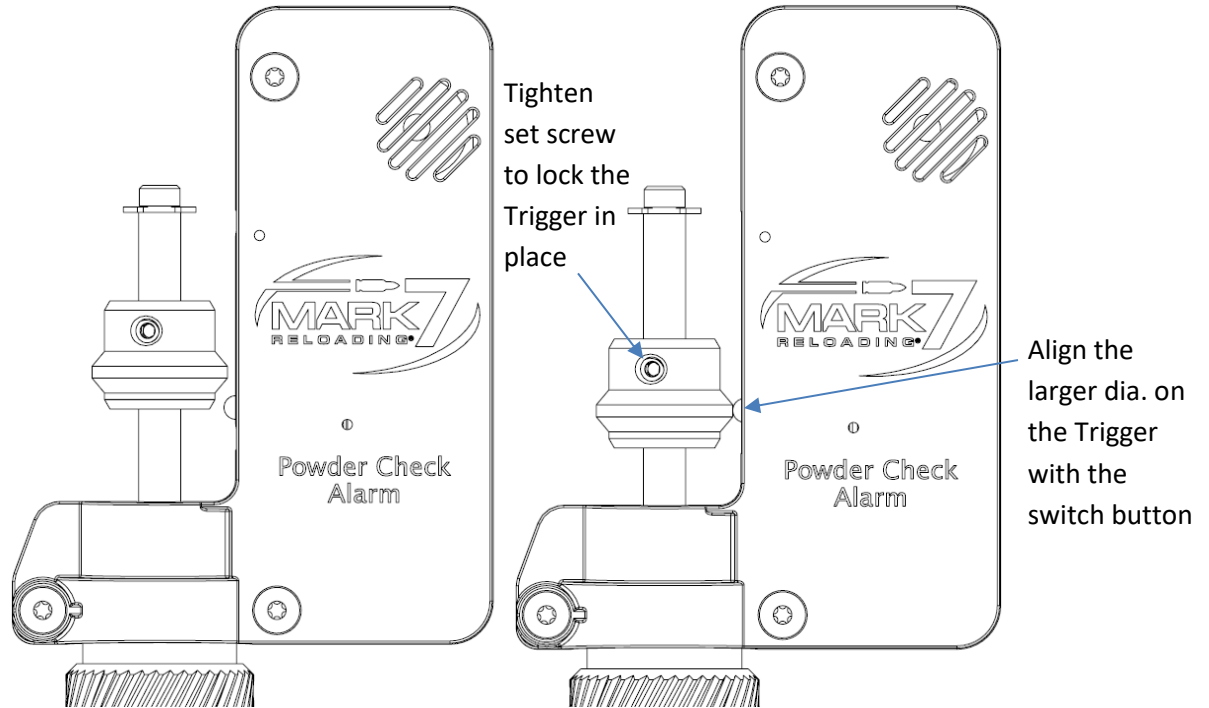

Figure 4: Trigger is not aligned with the switch (Left), Trigger is aligned with the switch completing setup (Right).

8. Test the alarm with a case containing no powder and one containing a double charge to ensure the alarm is working as intended.
9. Run your press normally. The alarm will sound when it detects a nonconforming powder load. **You must check the trigger rod after each alarm and reset it below the switch or it will continue to sound.**

## Troubleshooting

Refer to the knowledge base section on our website under **SUPPORT** for troubleshooting articles relating to setup and operation.

<https://www.markvii-loading.com/knowledgebase>

**Please contact us for technical support**

Phone: 1-888-462-7577

Hours: 9:00am-4:30pm, ET, M-F